

ST21 Loudspeaker Stands

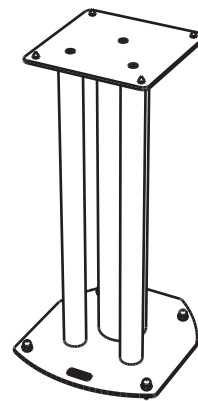

Thank you for purchasing these Epos ST21 Speaker Stands. They have been designed for use with M12.2 Loudspeakers.

Assembly



Kit list (per stand):

- Base Plate x1
- Top Plate x1
- Large Support Tube x1
- Small Support Tube x2
- Adjustable Floor Spike Plus bolt x4
- Dome Nut x4
- Top Spikes (Optional) x4
- M6 Hex Screw x6
- Allen Key x1
- 10/13mm Spanner x1

Dimensions:

- Top plate: 196 x 196 x 4mm
- Stand height (with spikes): 536mm
- Stand height (without spikes): 508mm

NOTE:

The height of the ST21 Stand is determined by the position of the Floor Spike Locking Nut. To adjust the height of the ST21 stand, you will need the supplied spanner and a Spirit Level. Simply decide on a suitable position, check with a Spirit Level and lock using the supplied spanner.

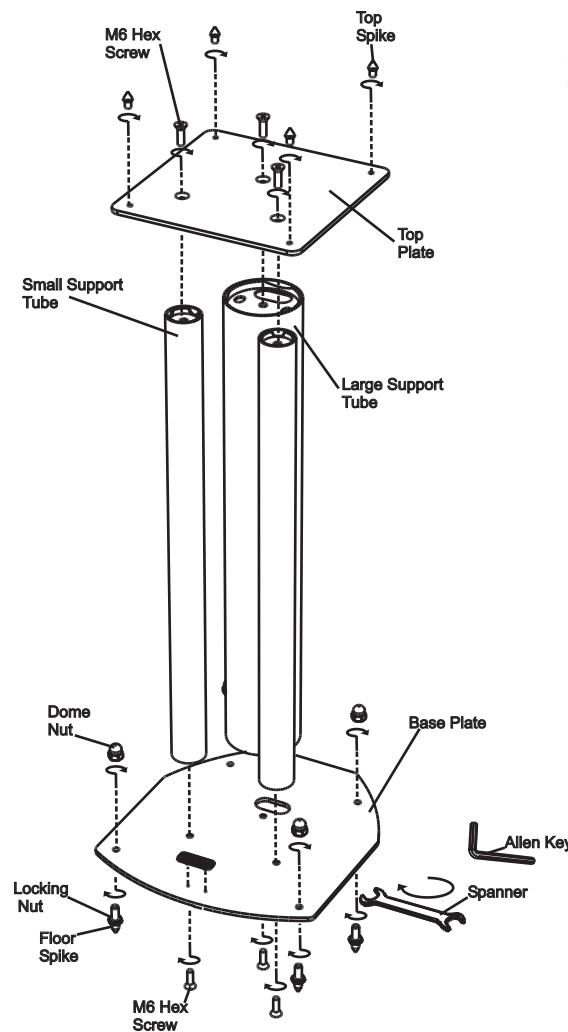

Cable management

The ST21 Cable management allows you to run speaker cable through the main support columns. We recommend running the cables through the main column prior to the connection of your loudspeakers. Making use of the Cable management system will allow you to run the cables at ground level, thus keeping cables tidy and in place.



Positioning

As every room is different, we strongly recommend that you experiment with the positioning of your loudspeakers. Place the speaker so the tweeter is at eye level (when sitting). Remember, the closer the speaker is to sidewalls or corners, the more bass is reflected back at the listener. If you find you are creating a 'BOOM' effect with positioning, try moving them out into the room to correct the balance of sound.

Finally, be sure you are happy with how your system sounds, if it sounds correct, then go with it!

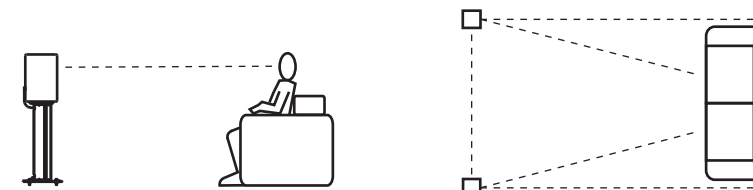

www.epos-acoustics.com

EPOS LIMITED, 12 AVEBURY COURT, MARK ROAD, HEMEL HEMPSTEAD, HP2 7TA. ENGLAND Tel: +44(0)1442 260146

Scale NTS (1:1 only)	Colour Definition Pantone	Drawing Title Epos ST21 Speaker Stand Instructions		Revisions & Date 1: 10/02/06 ORIGINAL 2: 27/02/06 LINE THICKNESS
Sheet N/A	Material 130gms Paper			3: 4: 5:
Drawn MW	Checked By	Signed off	Drawing No. EP-ST21-IM-AW-01	